

**COPENHAGEN
INSTITUTE
FOR FUTURES
STUDIES**





The future is a feature

NOT A BUG 

Velvet
INnovation
conference

NOVEMBER 2023

COPENHAGEN INSTITUTE FOR FUTURES STUDIES

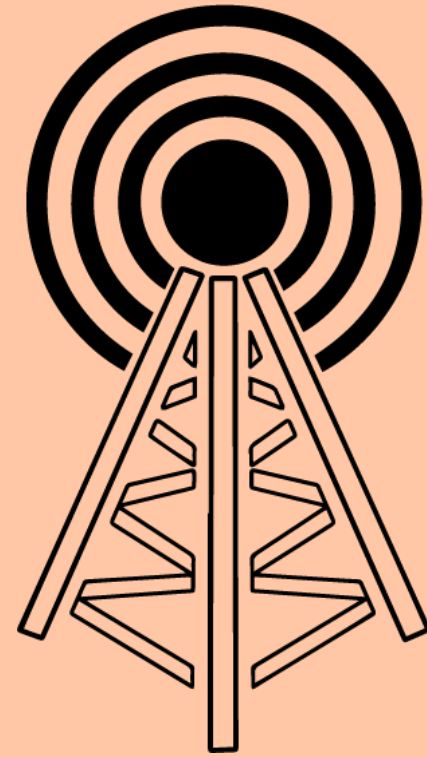

FUTURES PARTNERSHIP

ORGANISATIONAL

- **CIFS Strategic Monitoring** of critical trends and uncertainties
- **Trusted Advisor**, available for ongoing dialogue and sparring
- Either: 1) **One tailor-made presentation** about a topic of your choice OR 2) **Two course seats** on all our courses
- **Foresight Maturity Assessment** to make you futures-ready
- **10% discount** on small projects
- Quarterly editions of **FARSIGHT** (print & digital)
- 10 yearly **Futures Seminars** with futurists and experts
- Unlimited access to our **digital knowledge archive**



The mentioned services are on an annual basis.

DKK 59.000 annually*



Daria (Dasha) Krivonos
CEO at Copenhagen Institute for
Futures Studies



FUTURES MEMBERSHIP

INDIVIDUAL

- **10% personal discount** on all our **courses**
- Quarterly editions of **FARSIGHT** (print & digital)
- 10 yearly **Futures Seminars** with futurists and experts
- Unlimited access to our **digital knowledge archive**



DKK 800 annually*

*Ex. VAT.



THIS PRESENT
MOMENT
USED TO BE
THE UNIMAGINABLE
FUTURE

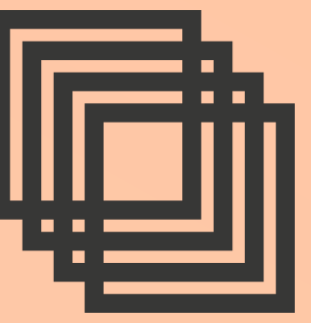

How to work with the future?

From gut feeling to structured analysis



Megatrends



Uncertainties



Unexpected events



... and understanding our own biases

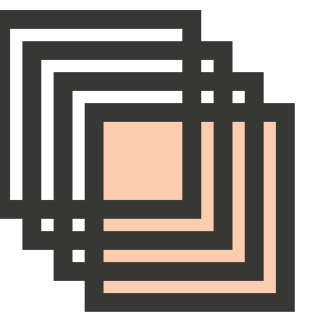

Know Your Cognitive Biases!

1. CHANGE IS BAD FOR BUSINESS

[The status quo bias]

2. WHEN IN DOUBT, GO WITH WHAT YOU KNOW

[The confirmation bias]

3. THIS IDEA IS SO GOOD IT COULDN'T POSSIBLY FAIL

[The optimism bias]

4. THE PROBLEM WITH EXPERTS IS THAT THEY DON'T KNOW WHAT THEY DON'T KNOW

[The expert problem]

5. HOW CONVENIENT THAT WE ALL THINK THE SAME

[Groupthink fallacy]





THE FUTURES TRIANGLE

A TOOL TO EXPLORE PAST, PRESENT, AND FUTURE DRIVERS AND TRENDS THAT SHAPE THE FUTURE

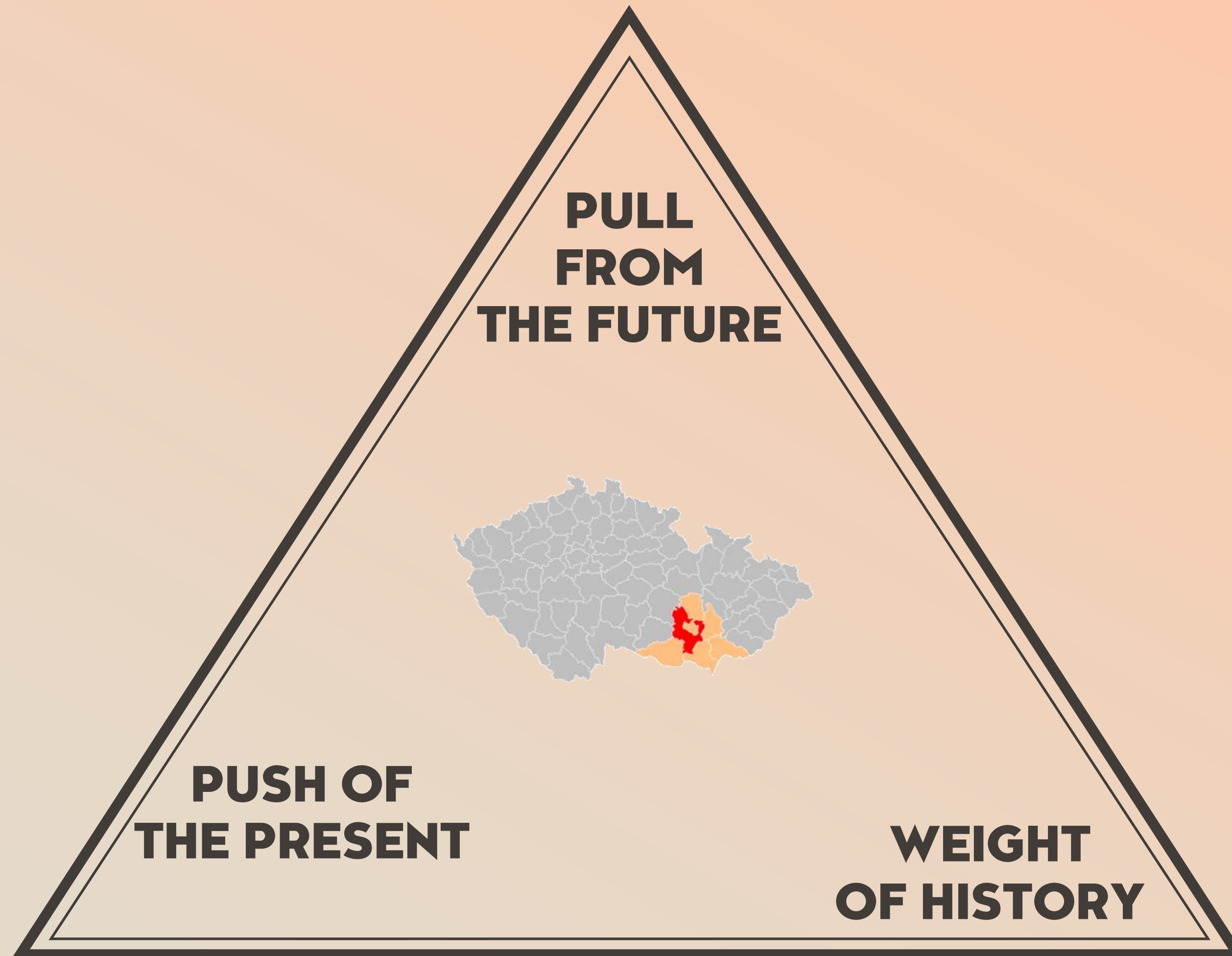

American Lifestyle Magazine 1950

IMAGINING HOW IT IS TO LIVE IN THE YEAR 2000



WHAT NONLINEARITY LOOKS LIKE



Built to Last ...

... or built to adapt?



...are you making decisions **today
based on **yesterday**
about **tomorrow**?**

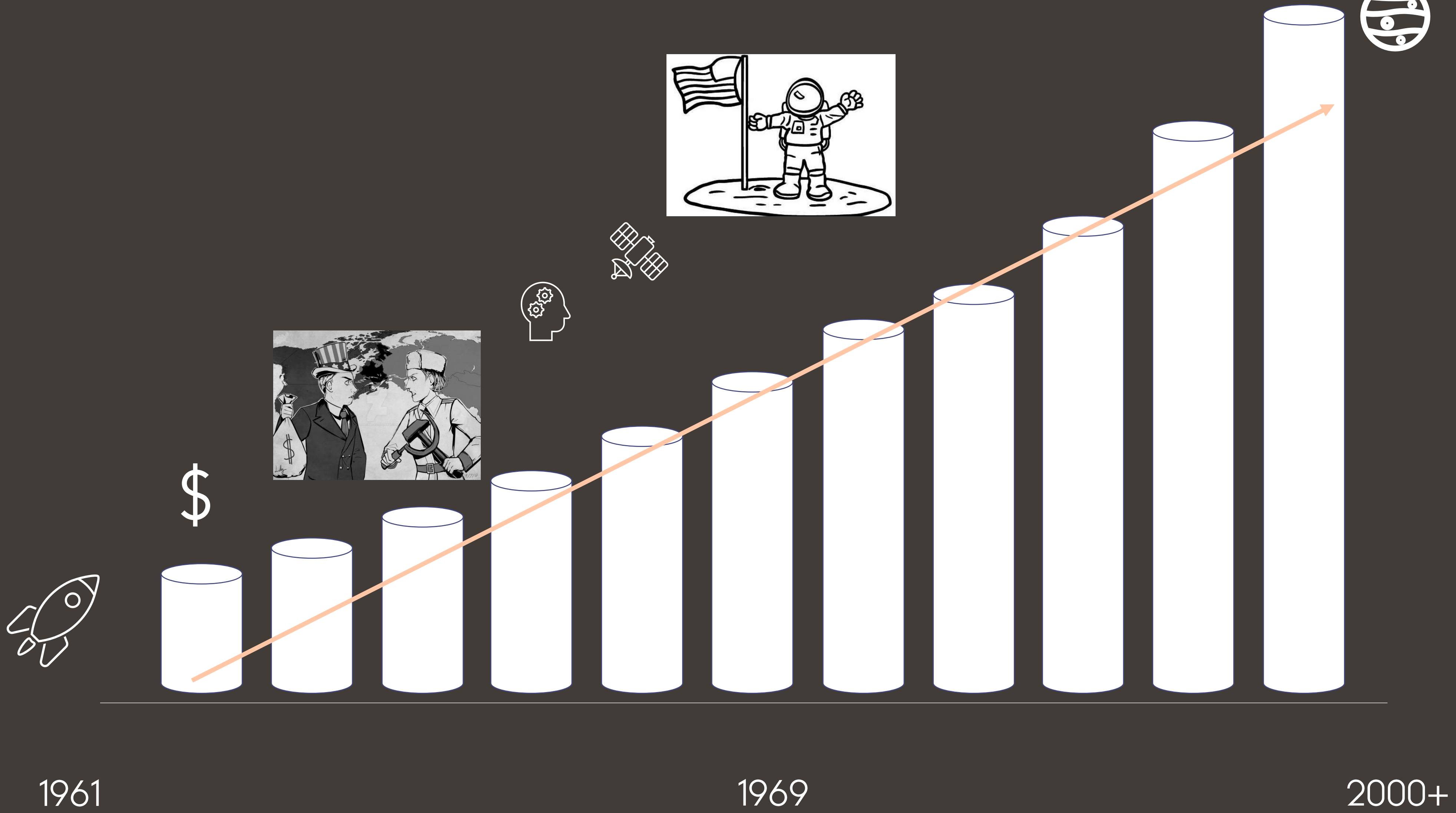

1961

1969

2000+

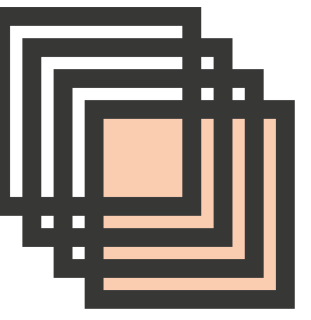

The trace you leave, the actions you take, the change you initiate



Footprint



Handprint

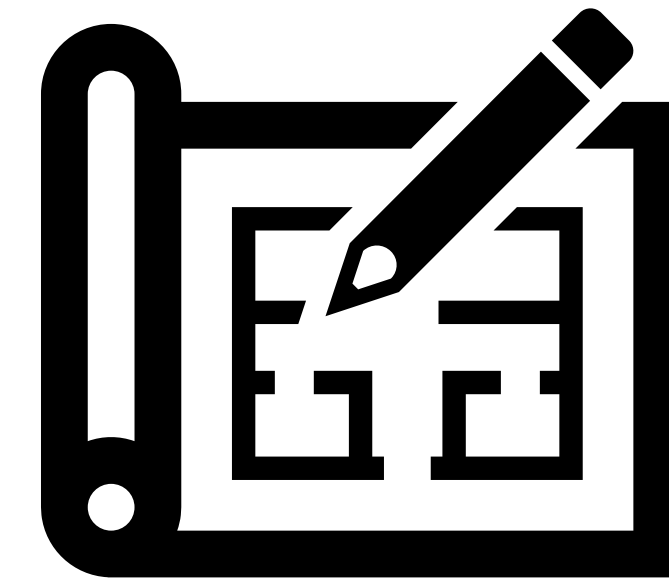

Blueprint

